

# WELCOME TO THE GROWBOX™

## Finally, no more brown thumbs!



Your GrowBox™ planter automatically creates the perfect growing environment that makes gardening easy for anyone.

Simply fill the planter completely to the top with potting mix, lay the Nutrient Patch™ cover on top of the moist soil and plant your plants or seeds through cuts in the cover. *It's that easy!*

The fertilizer tubes will dissolve into the soil and release an entire season's worth of specially formulated nutrients

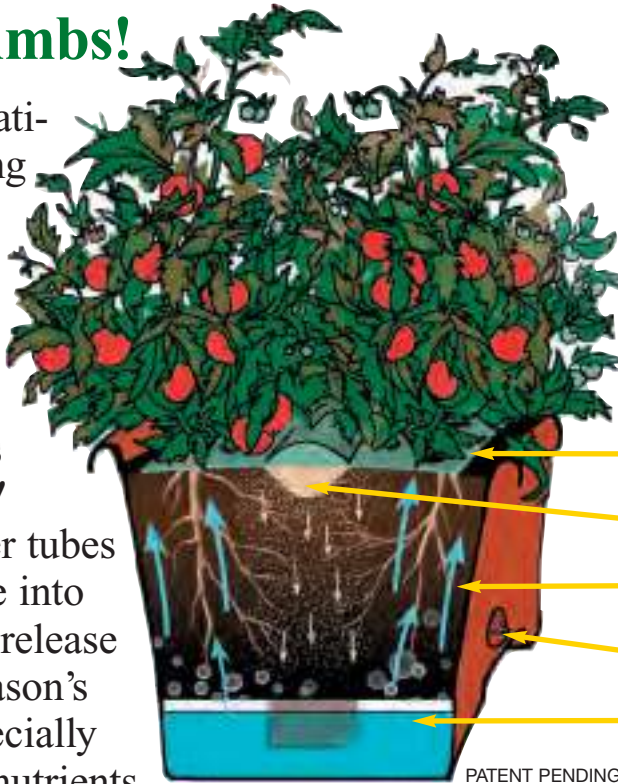

**Proven Design  
Makes Every  
Type of Plant  
Thrive  
-Follow  
These Easy  
Instructions for  
Spectacular  
Results**

- Nutrient Patch™
- Fertilizer Strip
- Potting Mix
- Water Spout
- Water Well

in a narrow strip on top of the soil. The plant roots will grow towards that fertilizer strip and automatically feed at their proper rate. Water from the built-in well will constantly move upwards towards the roots and keep them moist. **Leave the cover on** to protect the nutrient strip from rain and just **add water to the well through the side spout as needed.** It's that easy – follow these instructions and you'll never have to guess about when to add water or fertilizer again.



*Vine Ripe Tomatoes*

*Sweet Bell Peppers*



*Photo Winners*



*Philomena and Stephen L., Laflin, PA.*

*We love to see happy GrowBox™ gardeners showing-off their success. Send us your proud pictures for a chance to win a FREE GrowBox™*



**IMPORTANT:** The fertilizer tubes attached to the underside of the Nutrient Patch™ will immediately dissolve upon contact with water. **Keep the tubes dry until you place the Nutrient Patch™ on top of the potting mix.**

**Mail photo's to:  
GrowBox™ Photos  
PO Box 59  
St. Petersburg • FL • 33731  
Or e-mail to:  
photos@aGardenPatch.com**

# HOW TO SET UP YOUR GROWBOX™

## ASSEMBLY



1

Remove the 4 pins from the bottom of the planter top and set them aside. Join the two halves of the planter together – keeping the spouts on the same side. It's easiest to join the halves beginning at an angle – the top half has a small lip that will fit inside the bottom half at the short ends. Start there and align the side as you join the parts together.

When the edges and tabs are seamlessly lined up, snap the top firmly on to the 8 pins for a secure fit. (see next page) →

## FILLING / PREPARATION



3

4

5

Pour some potting mix into the top half of the planter and pack the two square holes with mix. This is how water from the well will “wick” upwards to water your plants from below.

Fill the planter half-way up with potting mix and soak it good with water. A small amount of mix will fall through the small holes in the screen, but that's OK.

Now **COMPLETELY FILL** the top half of the planter with potting mix. **Don't leave any space at the top lip – fill the planter with as much potting mix as it will hold** - even a bit higher in the middle and again soak the potting mix with water.

Lay the Nutrient Patch™ cover – tube side down, on top of the wet mix. The cover should be centered on the mix and the fertilizer tubes will immediately begin to dissolve and release the nutrients in a narrow strip (see next page) →

## PLANT BY THE NUMBERS



7

Chose what you want to grow and look at the **Planting Diagram** to see how many plants of that type should be used. Match your plants to the numbers. For example, you can grow 8 pepper plants at numbers 1-7-13-17 and 2-6-12 and 18. Or grow 6 mustard greens at numbers 1-9-17 and 2-10 and 18. **For tomatoes, just plant at numbers 3 and 16.** After you've selected, gently lift one side of the cover without disturbing the fertilizer strip and use scissors to cut from the edge to the selected numbers. Cut a small triangle over the number. This is where each plant will go. Repeat on the other side. To plant, lift back the flaps of your cuts and plant 2 to 3 inches into the soil beneath the triangle. Add a little water around each plant to remove any air spaces from the roots then replace the flaps around each stem. **The cover stays on top of the soil and the plant stems should extend upward through the cover.**



Finally, push the two hinged-gates down to the bottom of the planter until they click into an up-right position.



down the center. Lift one side of the cover and gently spray water on the fertilizer tubes to make sure they begin to dissolve. You can also use a sharp knife or scissors to carefully open the tubes, but be sure the fertilizer stays in a narrow strip on top of the potting mix – about 2 inches wide. Do not spread the fertilizer around or mix it into the potting mix – leave it in a strip on top of the soil and replace the cover. Gently push down on the cover top to sink the fertilizer 1/2 inch into the potting mix.

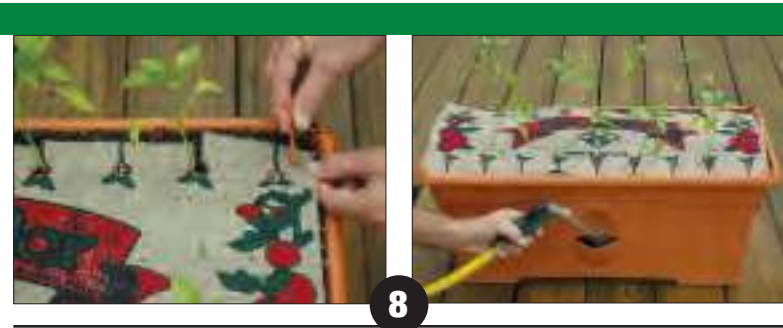

Push the 4 pins through the cover to secure it to the soil. Fill the water well through the side spout and add water when it gets low. There's no need to add any fertilizer for the life of those plants, just replace the Nutrient Patch™ with each new planting. Keep the water well full and *Happy Gardening!*



## 2 Plants per GrowBox™ at numbers 3 & 16

- Tomatoes ● Shrubbery
- Eggplant ● Dwarf fruit trees ● Roses

## 6 plants per GrowBox™ at numbers 1-9-17 & 2-10-18

- Artichokes ● Cantaloupe ● Cucumbers
- Greens – Turnip, mustard, collards ● Potatoes
- Squash ● Turnips ● Watermelon ● Zucchini

## 8 plants per GrowBox™ at numbers 1-7-13-17 & 2-6-12-18

- Arugula ● Bok Choy ● Broccoli
- Brussels Sprouts ● Cabbage ● Cauliflower
- Celery ● Chard ● Chinese Cabbage ● Garlic
- Herbs ● Kohlrabi ● Lettuces ● Okra ● Peppers
- Salads Greens ● Spinach

## 10 plants per GrowBox™ at numbers 1-5-9-13-17 & 2-6-10-14-18

- Beans ● Beets ● Carrots ● Corn ● Flowers
- Onions/Leeks ● Peas ● Strawberries ● Sunflowers



Mail photo's to:  
**GrowBox™ Photos**  
**PO Box 59**  
**St. Petersburg • FL • 33731**  
 Or e-mail to:  
[photos@aGardenPatch.com](mailto:photos@aGardenPatch.com)



# GROWBOX™ PLANTING GUIDE



## What To Grow:

Your GrowBox™ will grow almost any vegetable, flower, herb or berries. A good rule of thumb is to grow what plants are available from your local nursery or garden center. **If it's sold locally, then the timing and conditions are right to grow it locally. Place your GrowBoxes™ in a sunny spot** as most vegetable plants need 6-8 hours of sunlight per day. All plants are grown the same way so there's no need for special watering or fertilizer – just keep the water well full. Plants grow quickly in the GrowBox™, so **starting with smaller seedlings is actually better** than starting with larger plants. **Three-to six inch tall plants, sold in two-inch square pots transplant better, are easier to handle and are usually less expensive.**

## Tomato Tips:

**Start with the smallest plants you can find and plant them deep into the soil** – 2 inches deep or even up to the first small leaves. Adding two cups of dolomite or powdered lime will “sweeten” the potting mix pH which helps plants avoid blossom end rot. Mix the dolomite into the top of the potting mix before placing the Nutrient Patch™ cover. Plant just two plants, get yourself a **GrowBox™ Staking Kit** and get ready to make some sauce!

## What type of Potting Mix to Use:

The lightest and spongiest **POTTING MIX** works best. **Don't use heavy potting SOIL or garden SOIL** because they're too dense and won't wick water well. Find a brand that has lots of perlite or vermiculite. Some national brands are Lamberts, Fafards, Peter's Professional Mix, Pro-Mix, Sta-Green, Jungle Growth and Scotts. Brands with added fertilizer are OK, but Miracle-Gro® Organic Choice is a little too dense. Be sure to get **POTTING MIX, not POTTING SOIL**. Get the BIG bag. You'll need about 32 Quarts, 35.2Liters or 1.25Cubic Feet.

(Miracle-Gro® and Organic Choice® are registered trademarks of the Scotts Company, LLC)

## Water and Fertilizer:

Good news, The GrowBox™ automatically adds all the fertilizer your plants need for about 4 months – which is about as long as most vegetable plants will effectively produce. For perennials, herbs or ornamental shrubbery we suggest you replace the Nutrient Patch™ every 3 months. You can't over-water so just keep the water well from ever going dry.

## Should I mix and match plants:

Different types of plants can be grown in one GrowBox™ as long as the plants grow to similar heights at about the same rate. Don't let a large tomato vine choke out smaller salad greens or onions. It's best to plant an assortment of salad greens, or varieties of herbs, peppers, squash or flowers. Choose plants from the Planting Guide that recommend the same number of plants per GrowBox™.

**Now you're growing with the best! Our breakthrough blend contains critical minor elements (basically plant vitamins) not available in many other fertilizers. A powerful mix of fast acting and time released nutrients. Salts in fertilizers are responsible for burned and dried up plants. They also cause the fruit to start dehydrating once harvested. A typical 13-13-13 fertilizer contains 11% salts while your Nutrient Patch™ only contains 0.45% salts - that's over 2,300% less! No more burned plants and fruit that thrives and lasts longer off the vine too!**

### Garden Patch™ Premium Blend • Vegetable **PLUS+** FERTILIZER • 9 - 14 - 15

**For use in the Garden Patch™ GrowBox™ Planter.** Fill the planter completely to the top with potting mix, lay the Nutrient Patch™ cover (containing a premeasured amount of this fertilizer) on top of the moist soil, and plant your plants or seeds through the cuts in the cover.

#### GUARANTEED ANALYSIS:

**Total Nitrogen (N)** .....9.00%  
5.478%.....Ammoniacal Nitrogen  
2.577%.....Urea Nitrogen  
0.945%.....Water Insoluble Nitrogen  
**Available Phosphate (P<sub>2</sub>O<sub>5</sub>)** .....14.00%  
**Soluble Potash (K<sub>2</sub>O)** .....15.00%

**Magnesium (Mg)** .....0.65%  
0.65% Water Soluble Magnesium (Mg)  
**Sulfur (S)** .....5.0%  
5.0% Combined Sulfur (S)  
**Boron (B)** .....0.02%  
**Copper (Cu)** .....0.10%  
0.05% Water Soluble Copper (Cu)

**Iron (Fe)** .....0.50%  
0.10% Water Soluble Iron (Fe)  
**Manganese (Mn)** .....0.20%  
0.05% Water Soluble Manganese (Mn)  
**Zinc (Zn)** .....0.20%  
0.05% Water Soluble Zinc (Zn)

Derived from Diammonium Phosphate, Urea-formaldehyde, Urea, Sulfate of Potash, Sulfate of Potash Magnesia, Sodium Borate, Copper Sulfate, Copper Oxide, Iron (II) Sulfate, Iron Oxide, Manganese Sulfate, Manganese Oxide, Zinc Sulfate, and Zinc Oxide.

**Chlorine (Cl)** .....(maximum) 0.50% **F1899**

Information regarding the contents and levels of metals in this product is available on the internet at <http://www.aapfco.org/metals.htm>

**Manufactured Exclusively for and Guaranteed by: The Garden Patch™, PO Box 550, St. Petersburg, FL 33731**

NET WEIGHT 11 oz., (311g)

©2012 The Garden Patch™ • GrowBox™ • Nutrient Patch™ all rights reserved.

## Melons, Gourds and Spreading Plants:

Cantaloupe or watermelon in my GrowBox™? Yep, just allow lots of space around the planter for the vines to spill over the sides and expand along the ground.

## Starting With Seeds:

Seeds work great in the GrowBox™ and the planter acts as a starter kit so there's no need to pre-plant. Just cut out a one-inch circle around the numbers and plant 3-4 seeds into the potting mix through each hole. They'll find the sunlight and begin to grow. Thin-out the smaller sprouts and you'll reconnect with nature as you watch them grow straight and tall.

## Store for the winter:

There's no need to move your GrowBoxes™ out of the weather. Just remove and discard the Nutrient Patch™ cover and scoop out the fertilizer remnants. Let Mother Nature rinse and compost the soil and old roots over the winter for an even better crop next season.

## How to Replant:

Use the same potting mix for 3-4 years! To replant, remove and discard the old Nutrient Patch™ cover and scoop out the fertilizer remains. Pull out the old plants and loosen-up the top of the old soil. It's not necessary to remove the old roots. Add more potting mix to **COMPLETELY FILL** the planter. Lay down a new Nutrient Patch™ cover and plant a new crop. **The Nutrient Patch™ fertilizer is specifically formulated** for High-Density Gardening™ in the GrowBox™ and other container gardens. Our premium blend contains a powerful mixture of fast-acting and time-release nutrients as well as critical minor elements not found in many garden fertilizers. In addition, we've eliminated 95.5% of the harmful, plant-burning salts found in most off-the-shelf fertilizers. Ensure your gardening success, use a genuine Nutrient Patch™ cover each time you plant.

## Supporting Your Plants:

Tomatoes, beans, peas, peppers and many other plants need proper support to ensure that air-flow and sunlight get to your plants. **The GrowBox™ Staking Kit** is ideal for this purpose and can be added to the planter even after the plants are growing. Visit our Website for ordering information.

## The Garden Patch™ GROWBOX™

PO Box 458 • Department 2TGP8 • Louisiana, MO 63353  
Photos@aGardenPatch.com • Support@aGardenPatch.com

**Customer Service: 1-800-519-8144**

[www.aGardenPatch.com](http://www.aGardenPatch.com)

\*\* Best if used within 18 months of purchase.